

CHECK VALVE

Low Pressure Check Valves upto 6,000 PSI

Design No. ACV

FEATURES

- Instant shut off in upstream condition.
- Stops reverse flow in order to protect instrument.
- 100% factory tested for both crack & re-seal.

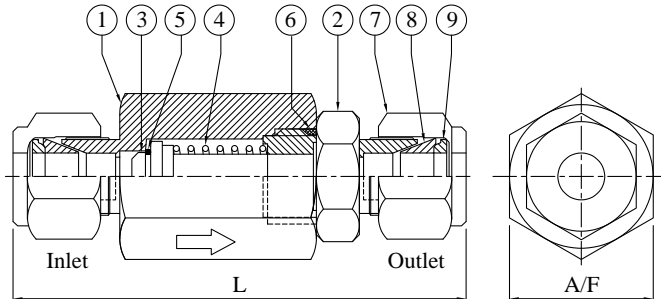

Material Construction

#	Component	Material
1,	Body	SS 316
2,	Adeplor	SS 316
3,	Poppet	SS 316
4,	Spring	SS 316
5,	O-ring	Viton
6,	Joint (O-ring)	Viton
7,	Nut	SS 316
8,	Front Ferrule	SS 316
9,	Back Ferrule	SS 316

	END CONNECTIONS		PRESSURE RATING 100°F (37°C) PSIG	DIMENSIONS MM		Cv
	INLET / OUT LET			L	A/F	
ACV/TO/02	FRACTIONAL TUBE FITTING	1/8"	6000	65	16	0.23
ACV/TO/04		1/4"	6000	75	19	0.47
ACV/TO/06		3/8"	6000	82	22	1.48
ACV/TO/08		1/2"	6000	88	27	1.70
ACV/TO/12		3/4"	5000	98	32	5.10
ACV/TO/16		1"	4700	108	38	8.12
ACV/TO/6M	METRIC TUBE FITTING	6mm	6000	75	19	0.47
ACV/TO/10M		10mm	6000	82	22	1.48
ACV/TO/12M		12mm	6000	88	27	1.70
ACV/TO/22M		22mm	5000	98	32	5.10
ACV/TO/25M		25mm	4700	108	38	8.12
ACV/MO/02	MALE NPT x TUBE FITTING	1/8"	6000	60	19	0.23
ACV/MO/04		1/4"	6000	68	22	0.47
ACV/MO/06		3/8"	6000	70	25	1.48
ACV/MO/08		1/2"	6000	82	27	1.70
ACV/MO/12		3/4"	5000	85	36	5.10
ACV/MO/16		1"	4700	92	45	8.12

SPECIFICATIONS

- Max. Working Pressure : up to 6,000 PSI (414 bar), 10,000 PSI on request
- Temperature Ratings : upto 400 F (204 °C)
- Nom. Cracking Pressure : 3, 10, 25 PSI (0.07, 0.69, 1.72 bar)
- Optional cracking pressures up to 100 PSI
 - End Connections : Tube
 - NPT in male and female
 - ISO taper thread in male and female
 - DIN and JIC 37°

TYPICAL APPLICATIONS

- Gas
- Liquid
- Fluid handling for the chemical/petrochemical, research, and oil and gas industries

TYPICAL MATERIALS

- 316 Stainless Steel
- Other material on request.

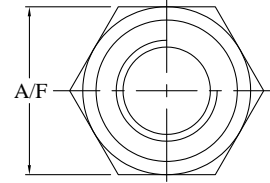
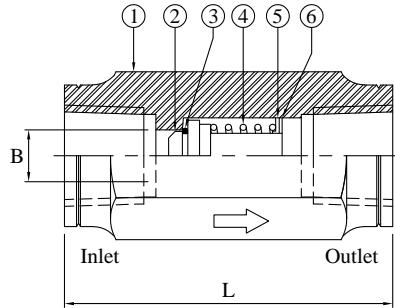

Material Construction

#	Component	Material
1,	Body	SS 316
2,	Poppet	SS 316
3,	Seat Seal	Viton
4,	Spring	SS 316
5,	Spring Guide	SS 316
6,	Stopper	SS 316

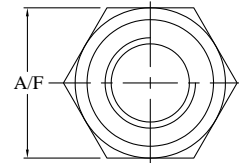
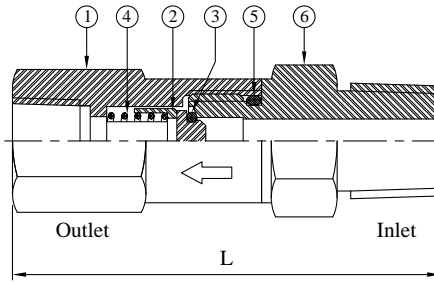

Material Construction

#	Component	Material
1,	Body	SS 316
2,	Poppet	SS 316
3,	Seat Seal	Viton
4,	Spring	SS 316
5,	Joint Seal	Viton
6,	Adaptor	SS 316

	END CONNECTIONS		PRESSURE RATING 100°F (37°C) PSIG	DIMENSIONS MM		Cv
	INLET / OUT LET			L	A/F	
ACV/FF/02	FEMALE x FEMALE NPT	1/8"	6000	55	19	0.78
ACV/FF/04		1/4"	6000	58	22	1.31
ACV/FF/06		3/8"	6000	58	25	1.52
ACV/FF/08		1/2"	6000	65	27	1.68
ACV/FF/12		3/4"	4300	70	36	4.85
ACV/FF/16		1"	4100	82	45	8.30
ACV/MM/02	MALE x MALE NPT	1/8"	6000	60	19	0.82
ACV/MM/04		1/4"	6000	68	22	1.40
ACV/MM/06		3/8"	6000	70	25	1.52
ACV/MM/08		1/2"	6000	82	27	1.70
ACV/MM/12		3/4"	5000	85	36	4.85
ACV/MM/16		1"	4100	92	45	8.30
ACV/MF/02	MALE x FEMALE NPT	1/8"	6000	60	19	0.82
ACV/MF/04		1/4"	6000	68	22	1.40
ACV/MF/06		3/8"	6000	70	25	1.52
ACV/MF/08		1/2"	6000	82	27	1.70
ACV/MF/12		3/4"	4300	85	36	4.85
ACV/MF/16		1"	4100	92	45	8.30



Arya Crafts & Engineering Pvt. Ltd.

102, Vora Industrial Estate #4, Navghar,
Vasai Road (E), Mumbai 401 210, India.
Tel +91-250-239 2246 / 0046 Fax +91-250-239 3423
Email : engcrafts@vsnl.net http://www.aryaengg.com

Note : Dimensions are reference only and are subject to change.

Warning for Your Safety

The system designer and user have the sole responsibility to select products suitable for their special application requirements to ensure the proper installation. Operation and maintenance of the product. Application details, material compatibility and product ratings should all be considered in the individual selection. Improper selection or use of products can cause property damage or personal injury. Arya accept no liability for any improper selection, installation, operation or maintenance.